



141 Rodeo Drive
Edgewood, NY 11717
Toll Free 888.444.4720
www.tiitech.com

Model: 761-RJ45-TII
Flush Mount Ethernet Jack



Installation Note

Description

1. The 761-RJ45 is a surface mount CAT6 compliant Ethernet jack. It utilizes tool-less IDC connections for wire terminations.
2. The Ethernet jack is intended to connect to the ONT.
3. The 761-RJ45 is for indoor use only.

Installation

1. The 761-RJ45 is designed to be mounted to a standard single gang electrical wall box or surface mount enclosure such as 761-WB1.
2. Locate the outlet box where the Ethernet jack is desired and pre-wired.
3. Strip outer jacket of the Ethernet cable, exposing about 2 inches of the 4 wire pairs.
4. Untwist each wire pair such that each pair has approximately 1/2 inch of straight wire.
5. Clean cut each wire pair using a diagonal cutter.
6. DO NOT STRIP WIRES.
7. Lift open all IDC rockers until they snap into the upper detent position.

Caution: Do not rotate rockers beyond the upper detent position.

8. Following the appropriate color code for either T568A or T569B, insert each wire pair into the appropriate rocker. Visually inspect that the wire pair is fully inserted and bottoms out in its hole.
9. Push down the IDC rocker to the closed position. Visually inspect that the wires remained fully seated and are terminated by the IDC contacts. Gently tug the wires for additional verification.
10. Repeat for other wire pairs.

11. Strain relieve the Ethernet cable using a tie wrap.
12. Mount the wall plate to gang box using supplied screws.

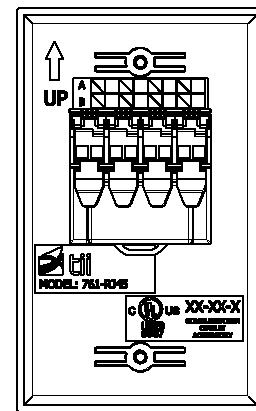

Figure 1

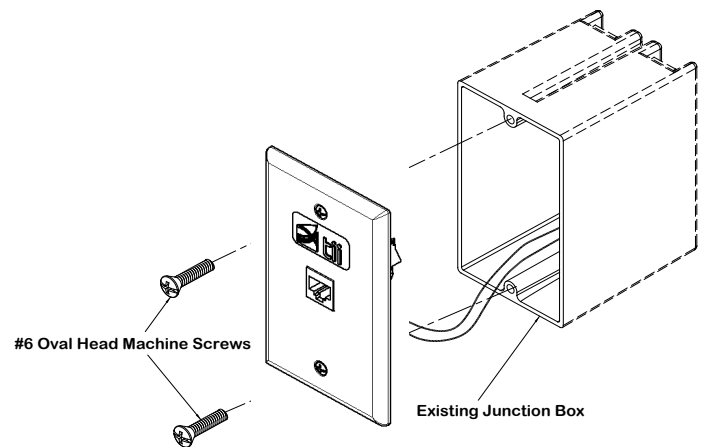

Figure 2