

141 Rodeo Drive  
Edgewood, NY 11717  
Toll Free 888.844.4720  
www.tiitech.com

## INSTALLATION NOTES



**MODEL: HCCH FDH 144**  
**MODULAR FIBER DISTRIBUTION HUB (FDH) ENCLOSURE**

### WALL MOUNTING

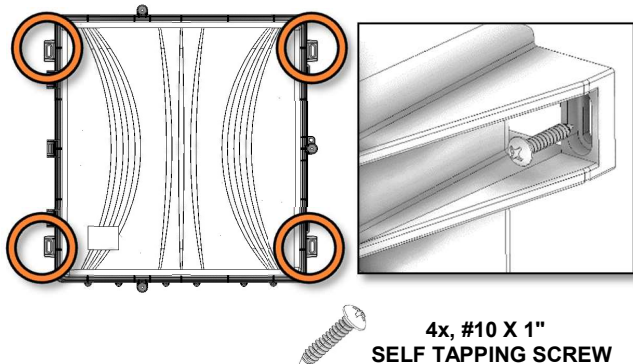

### POLE MOUNTING

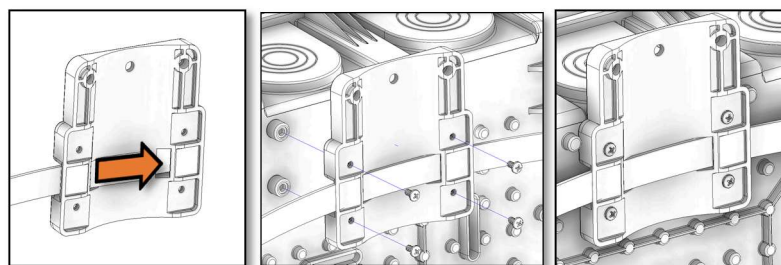

### 1. OPENING THE OUTSIDE DOOR

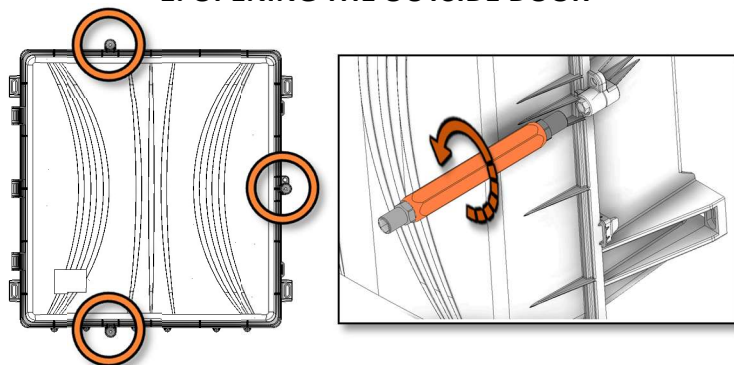

### 2. OPENING THE PORT CAPS

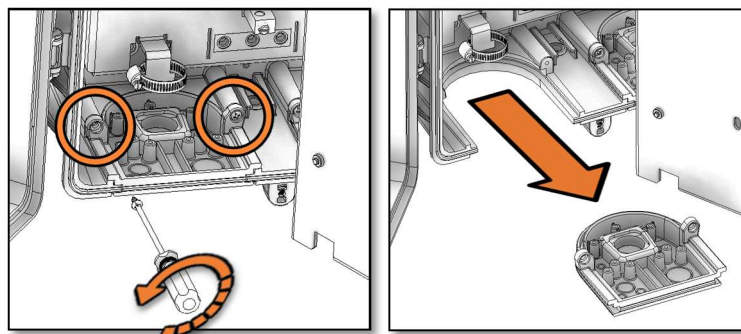

### 3. OPENING THE INSIDE DOOR

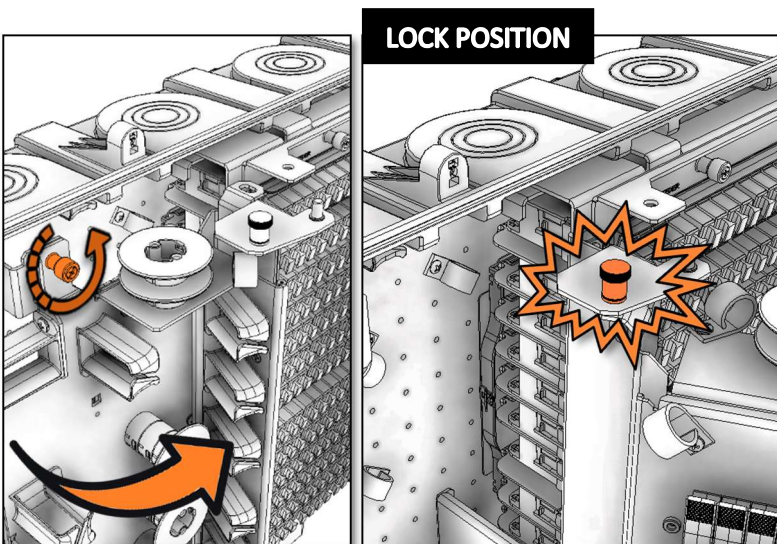

### 4. INSTALLING CABLES THROUGH THE PORT CAPS (DIVIDED CAP)

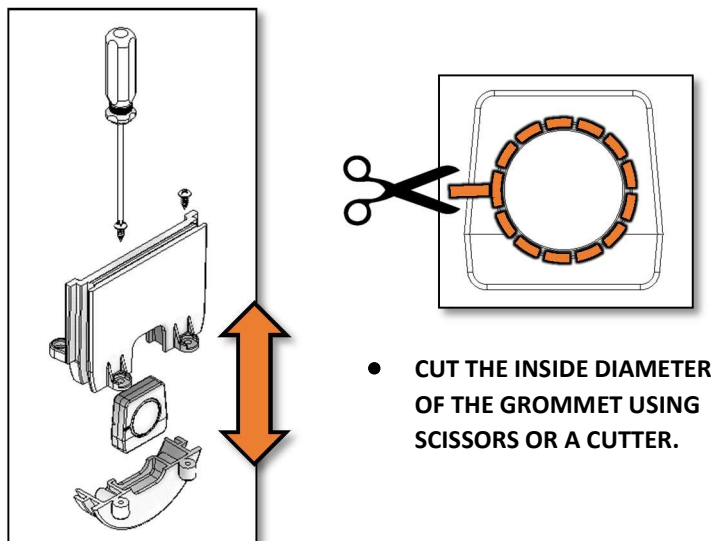

**INSTALLING CABLES THROUGH THE PORT CAP (DIVIDED CAP) CONT.**

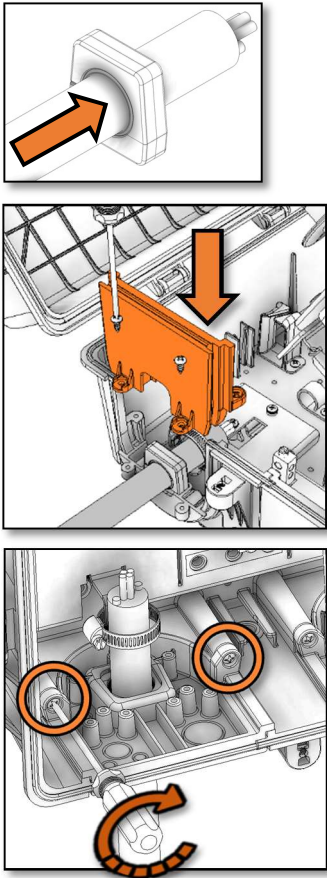

**INSTALLING CABLES THROUGH THE PORT CAPS**

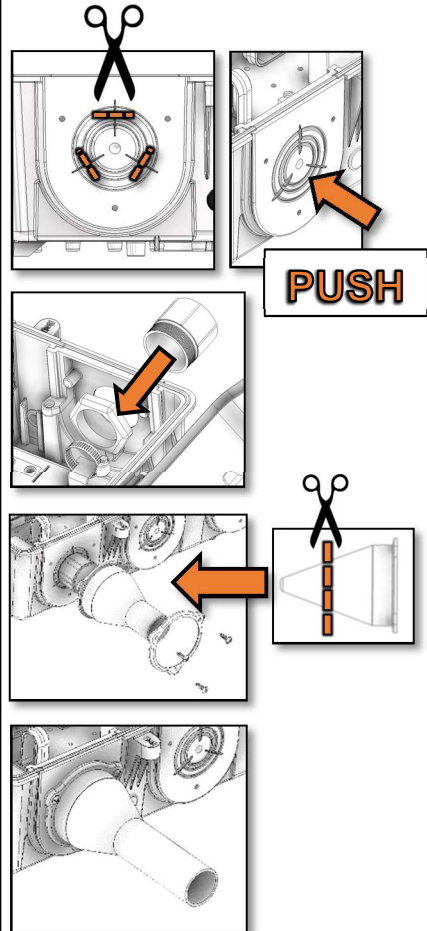

**INSTALLING CABLES THROUGH THE PORT CAPS (SOFT CAP)**

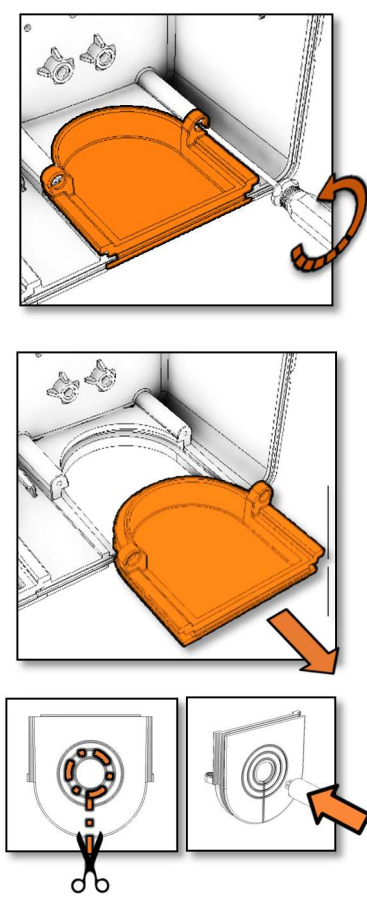

**5. SECURING THE FEEDER CABLE STRENGTH MEMBER AND JACKET**

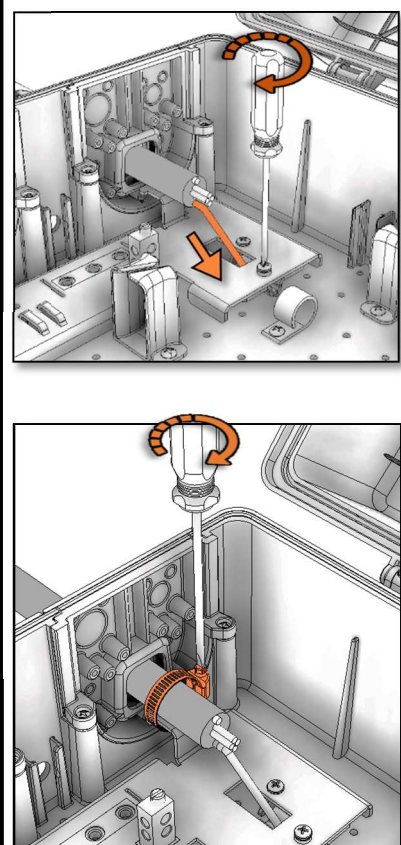

**6. ROUTING TUBES AND SPLICING**

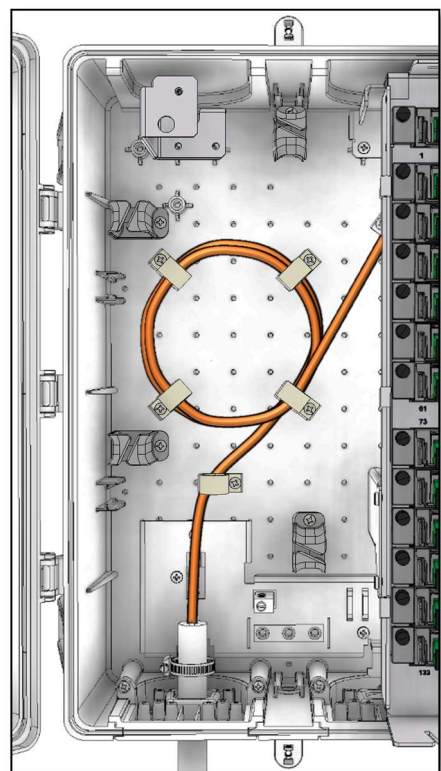

**FROM THE OUTSIDE SOURCE**

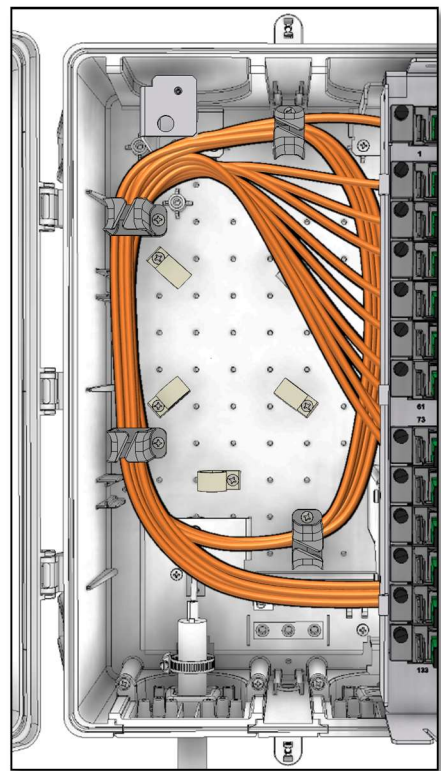

**FROM FEEDER CASSETTE**

**FROM FEEDER CABLE**

**FROM INPUT CASSETTE**

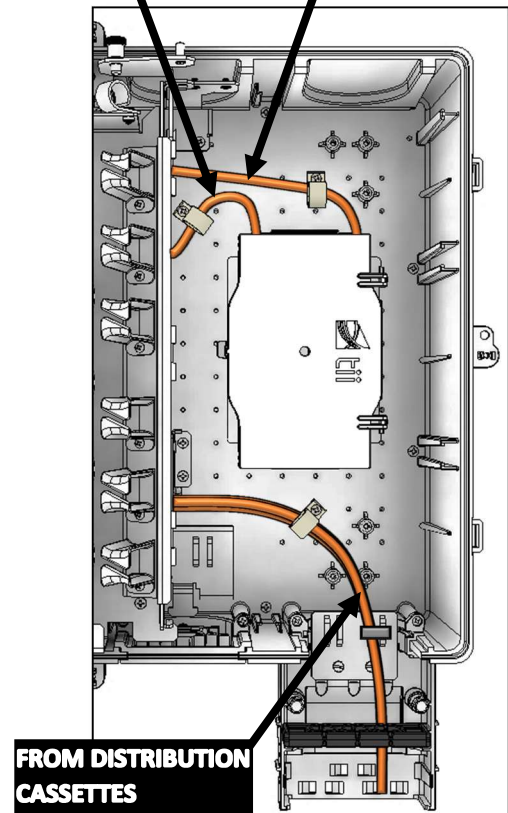

**FROM DISTRIBUTION CASSETTES**



6. ROUTING TUBES AND SPLICING (CONT.)

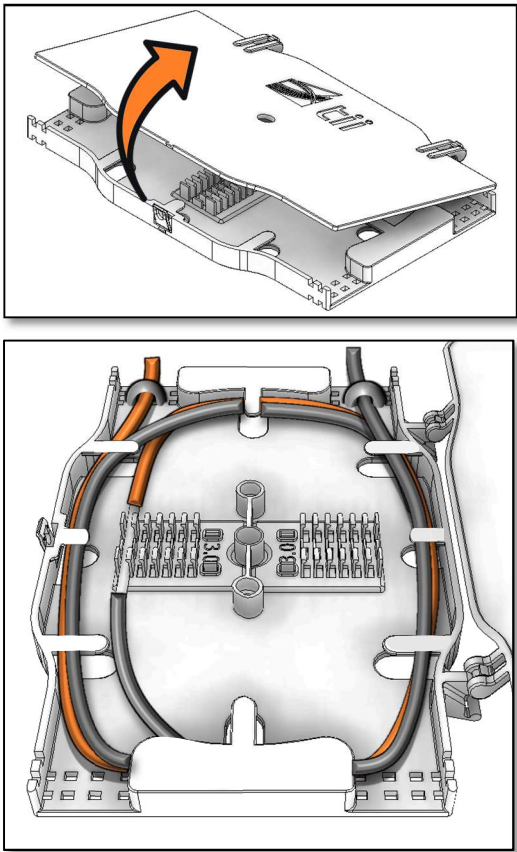

7. REMOVING AND STORING THE DISTRIBUTION PANEL.

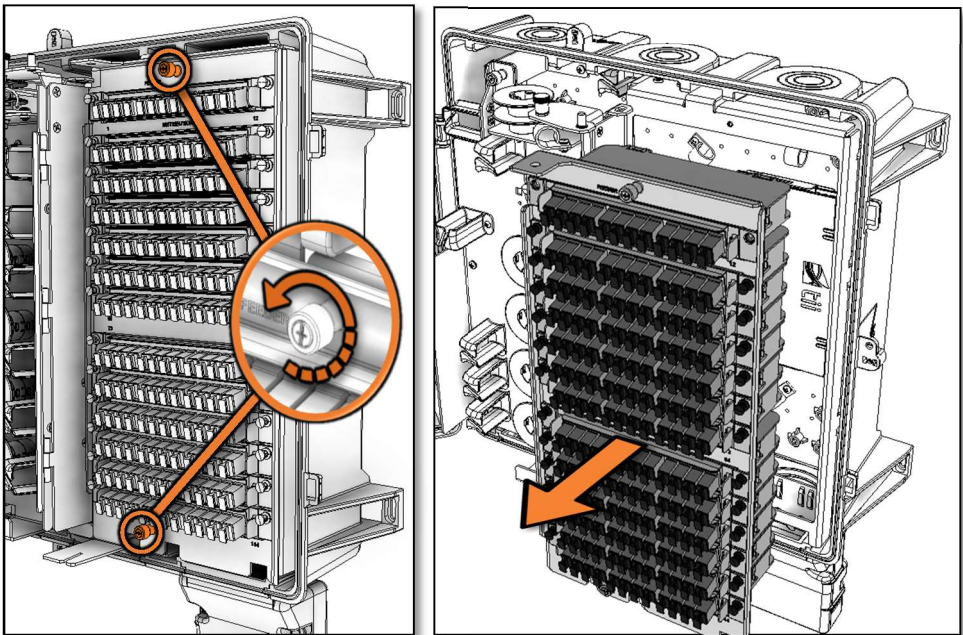

8. INSTALLING THE CASSETTES.

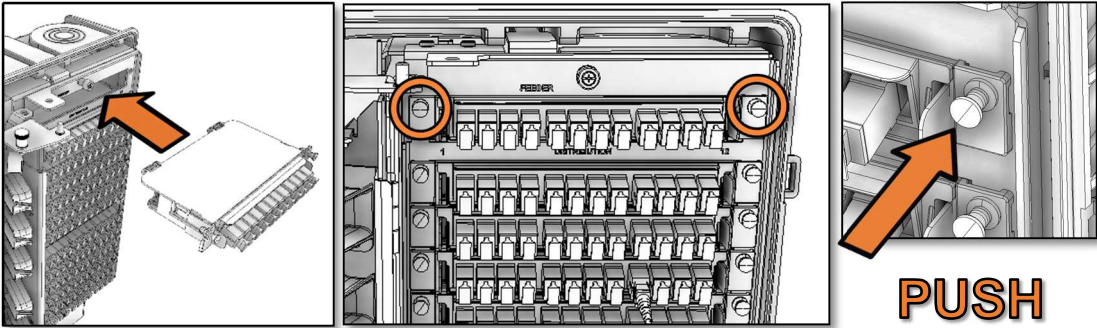

9. REMOVING THE CASSETTES.

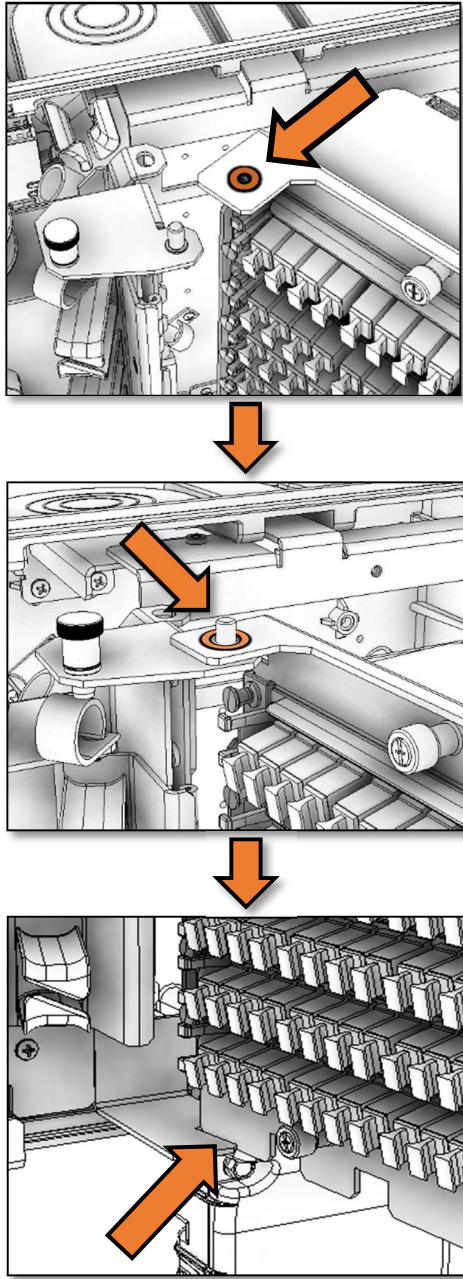
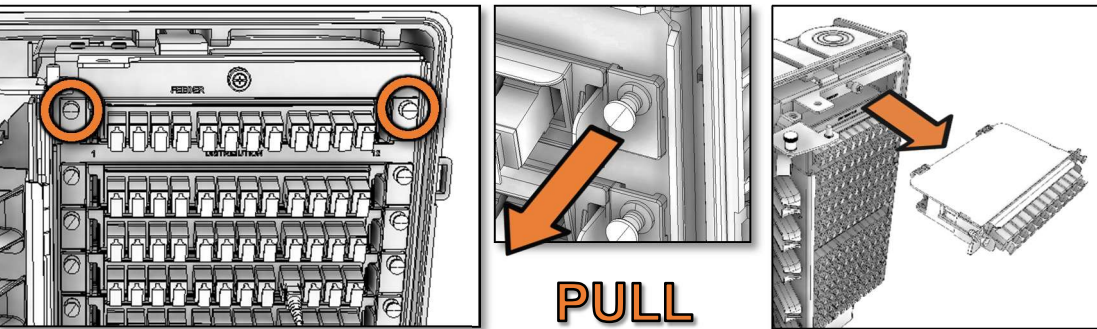

10. INSTALLING THE DISTRIBUTION CABLE

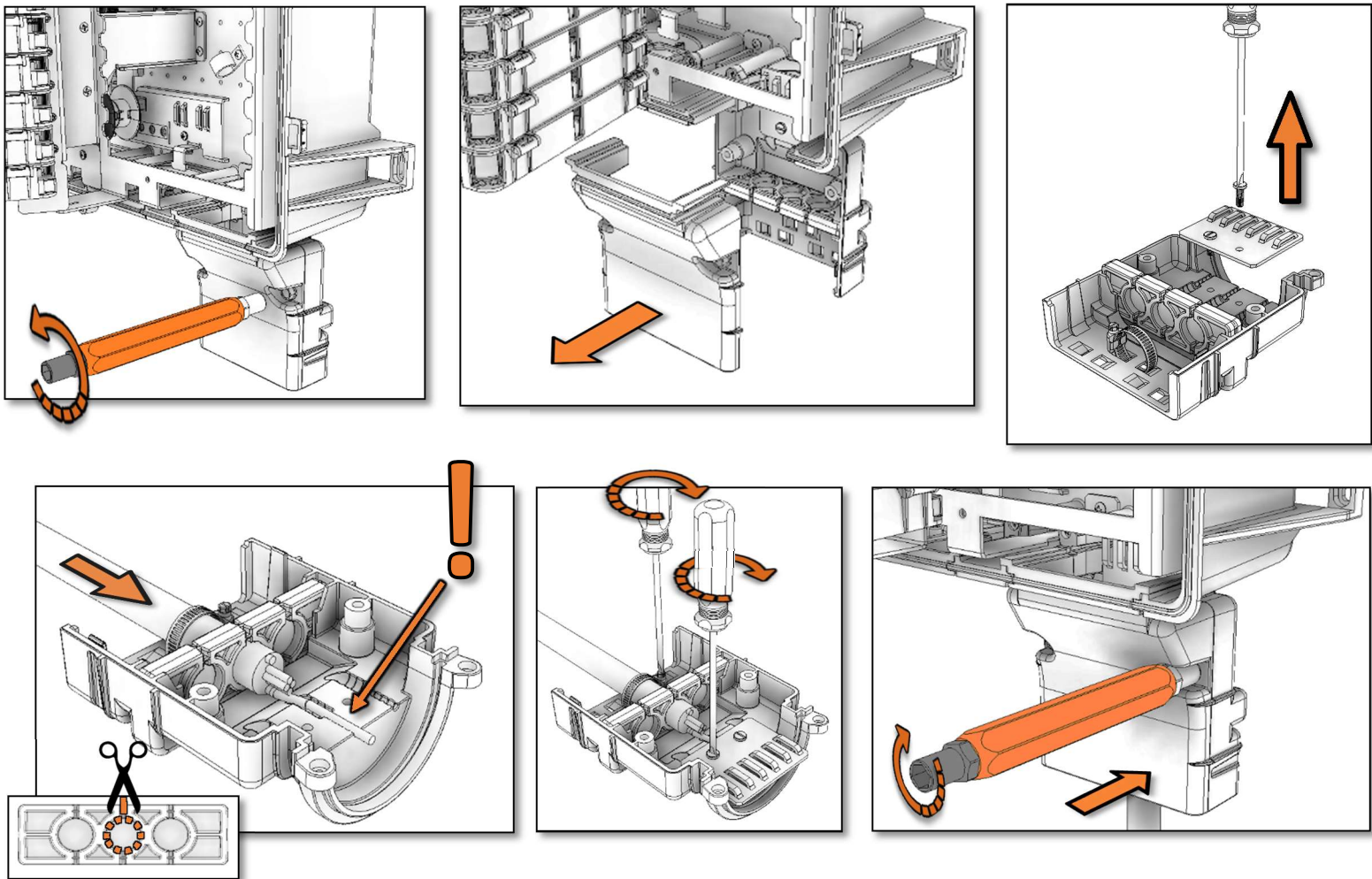

12. INSTALLING THE SPLITTER MODULE (LPS0)

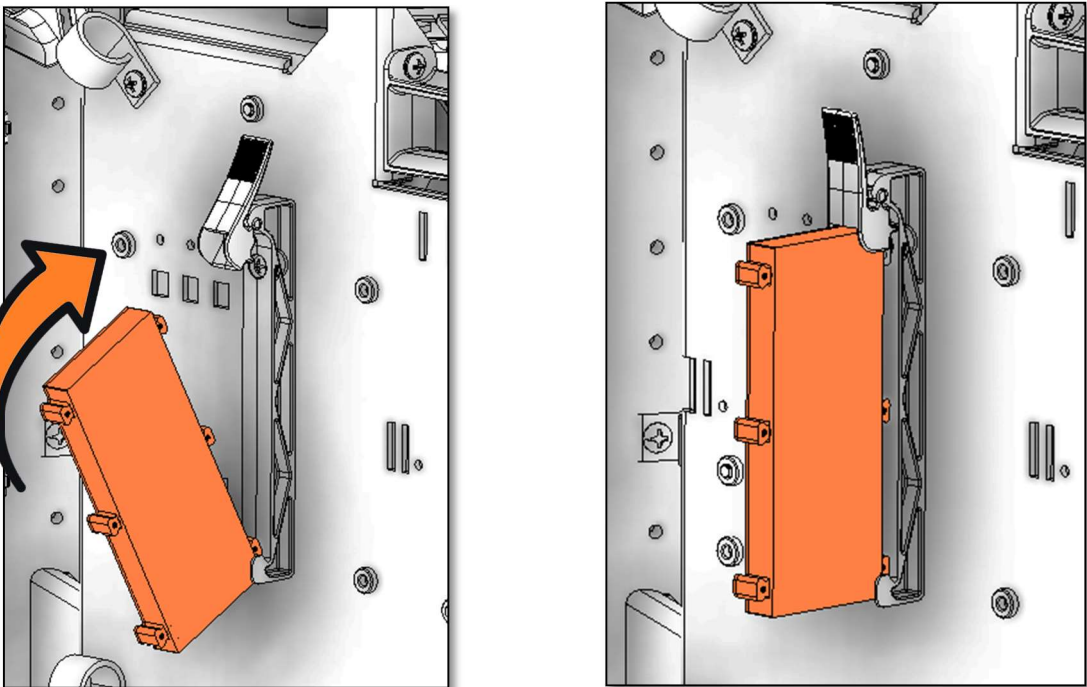



## 12. INSTALLING THE SPLITTER MODULE (CONT.)

### ROUTING INPUT TAIL

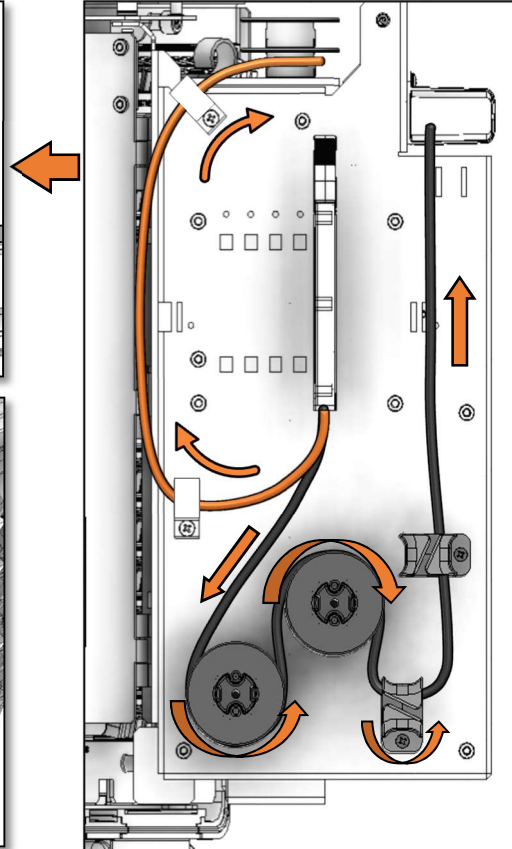
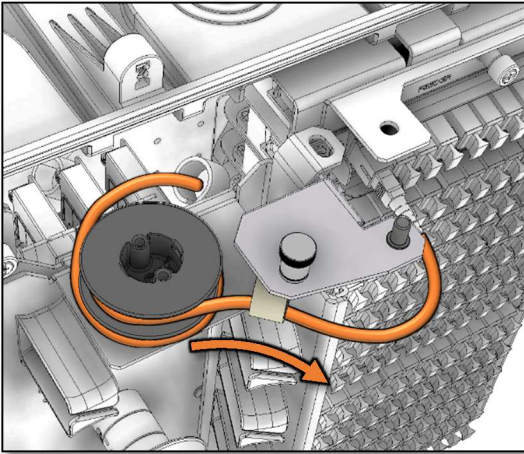
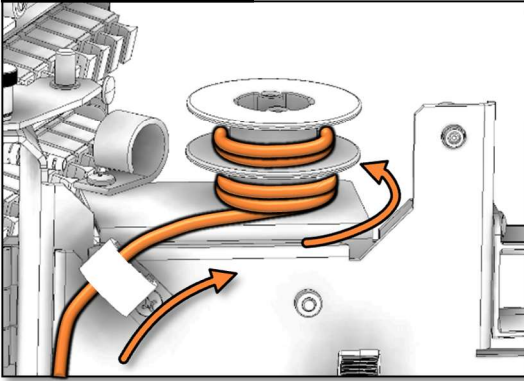

USE TOP CLIP TO GUIDE TAILS TO THE FRONT

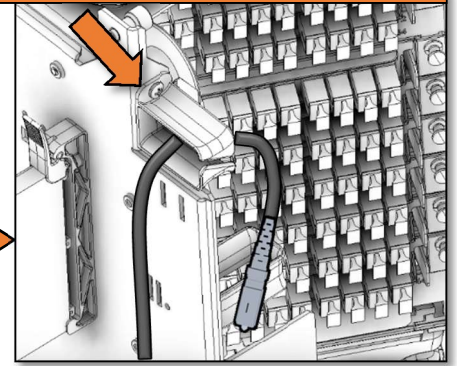

### NON CONNECTED TAILS STORAGE

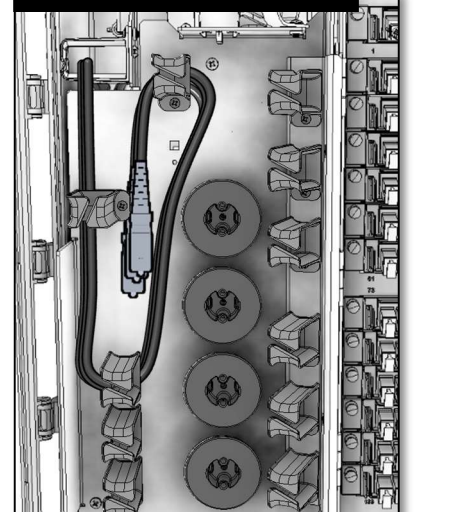

### ROUTING TAILS TO THE DISTRIBUTION

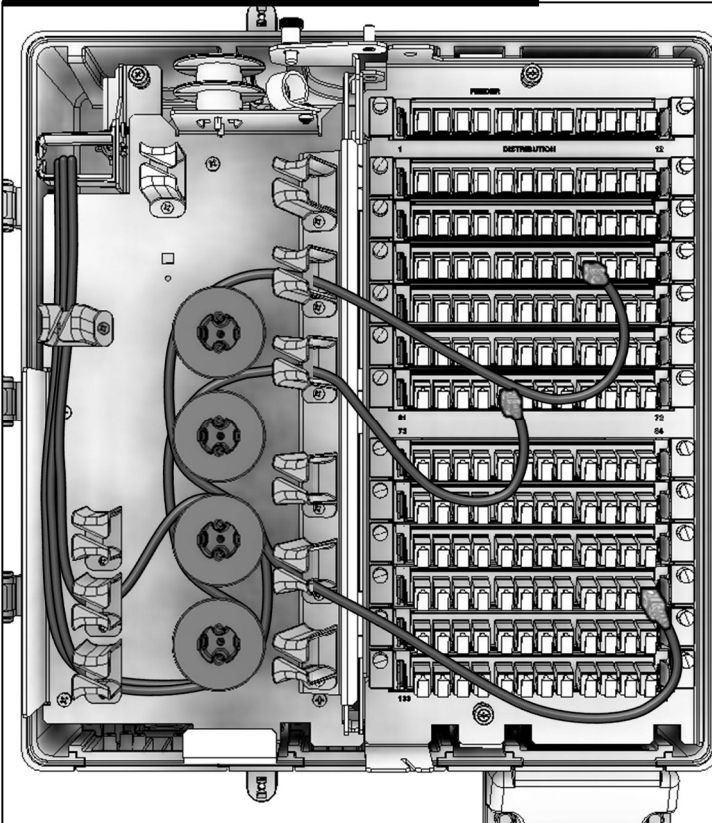

### PASSTHRU FIBER ROUTING

