

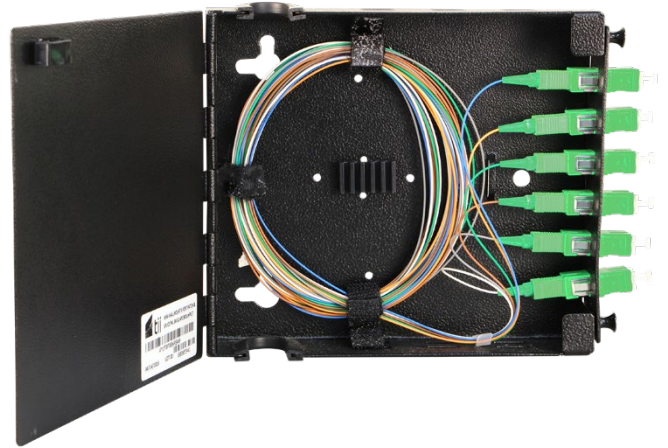

141 Rodeo Drive
Edgewood, NY 11717
Toll Free 888.844.4720
www.tiitech.com

Model WM1PBF
WALL MOUNT PATCH & SPLICE FIBER ENCLOSURE



Installation Note

Description

Compact wall mount fiber distribution unit designed to support patching and splicing in one unit. The enclosure has an integrated splice chip, 1 adapter panel and accommodates a wide variety of fiber termination connector types. Two compartments separate the network terminations from the distribution terminations and the unit has a single outer door with optional key lock.

Features

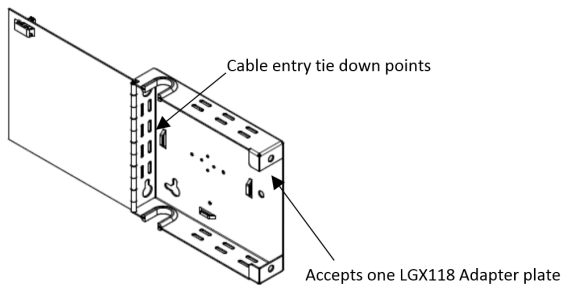

Installation

The WM1PBF is designed for indoor installation. It can be ordered empty and configured on-site or factory loaded with adapter plates, pigtailed and splice trays to reduce the installation time.

1. Verify contents and inspect for damage

2. Vertical wall surface - Easily accessible
3. Adequate clearance from electrical light fixtures, equipment and power circuits.

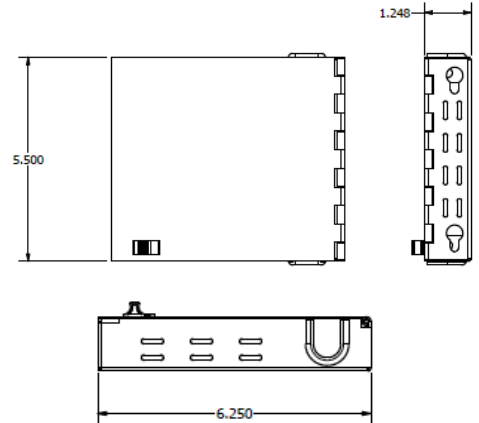

4. Mark and install appropriate wall hanging hardware and secure the unit.

