

INSTALLATION NOTE



1. DESCRIPTION

- 1.1 The TII-SVWJ is a microprocessor controlled circuit that provides seam less switching from Telco service to digital phone service.
- 1.2 The TII-SVWJ utilizes gel sealed insulation displacement terminations that provide reliable connectivity.
- 1.3 The second ringing voltage appearance on the digital phone service initiates the switch over.
- 1.4 The TII SVWJ is for indoor use only.
- 1.5 The SVWJ gets it's power from the Digital Voice Service line and switches after validating telephone ringing voltage presence.
- 1.6 The SVWJ can be reset by using the reset push button access provided on the back of the device. The circuit needs to be powered to activate switching in.
- 1.7 IDC rockers are used to terminate 26-22 AWG solid wire.
- 1.8 The SVWJ comes equipped with a galvanized steel wall mounting plate for use in existing retrofit construction installations.

2. WARRANTY

See TII Warranty. If this unit fails during the warranty period, the factory should be requested to authorize return. Return the unit prepaid. Units that fail due to normal wear or abuse should be discarded.

3. INSTALLATION

- 3.1 Remove the unit from the bag and inspect it for damage. If damaged, obtain another unit
- 3.2 Locate the existing phone jack outlet box that first enters the premises and disconnect the incoming telephone service to the RJ-11.
- 3.3 Place the SVWJ on flat surface so IDC's are easily accessible (See Figure 1).
- 3.3 Pull both rockers to the full open positions, insert wires as shown in Figure 1 until they bottom out, do not strip wires.
- 3.4 Push both rockers to the closed position for termination.

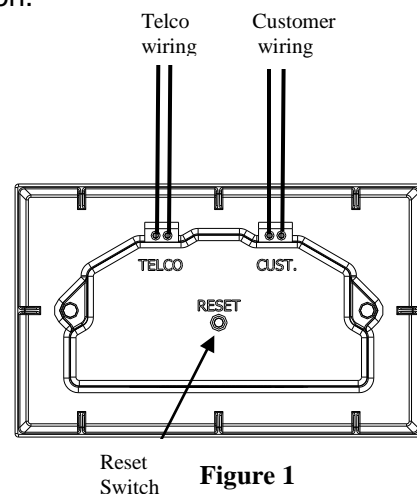

- 3.5 Using an RJ-11 plug wire the digital voice service wires from the ATA/EMTA to the MTA receptacle on the front face plate.
- 3.6 Connect existing phone from this location into the phone RJ-11 receptacle on the front face plate.

3.7 RESET

3.7.1 Confirm that the power is connected to the MTA RJ-11 receptacle of the SVWJ.

3.7.2 **Gently** push the reset button once with a blunt object to ensure the service to the customer is from the Telco Service Provider (See Figure 1).

NOTE:

THE RESET SWITCH IS DISABLED DURING RINGING VOLTAGE PRESENCE AND TEN SECONDS AFTER THE LAST RINGING VOLTAGE.

CAUTION:

TO AVOID PERMANENT DAMAGE TO RESET BUTTON DO NOT USE EXCESSIVE FORCE OR A POINTED OBJECT TO ACTIVATE THE RESET BUTTON.

3.8 Dress the wires properly inside the junction box and secure the SVWJ to the junction box using the supplied #6 oval head screw's (See Figure 2).

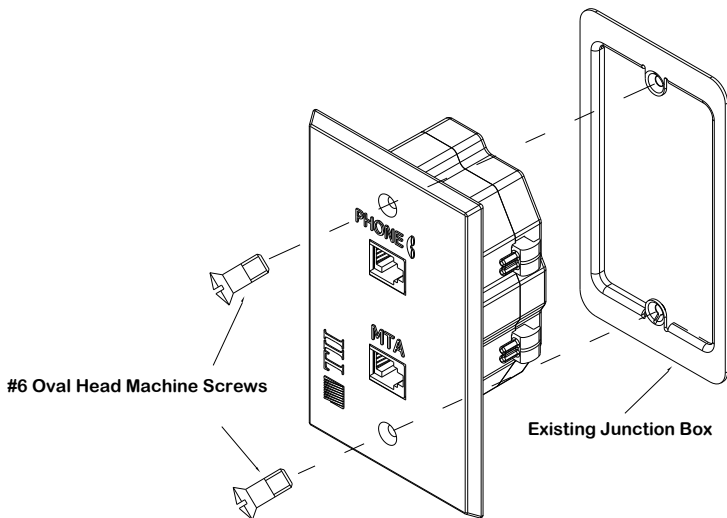

Figure 2

3.9 Existing Construction Installation

3.9.1 Cut drywall 2" W x 3.5" L in the location where the SVWJ is going to be mounted. **Prior to cutting hole confirm that there are no obstructions behind wall.**

3.9.2 After drywall has been cut, install the wall mounting plate. Bend the two mounting tabs behind the drywall and secure the mounting plate with the supplied drywall screws (See Figure 3). Align the mounting tab slots while tightening the screws.

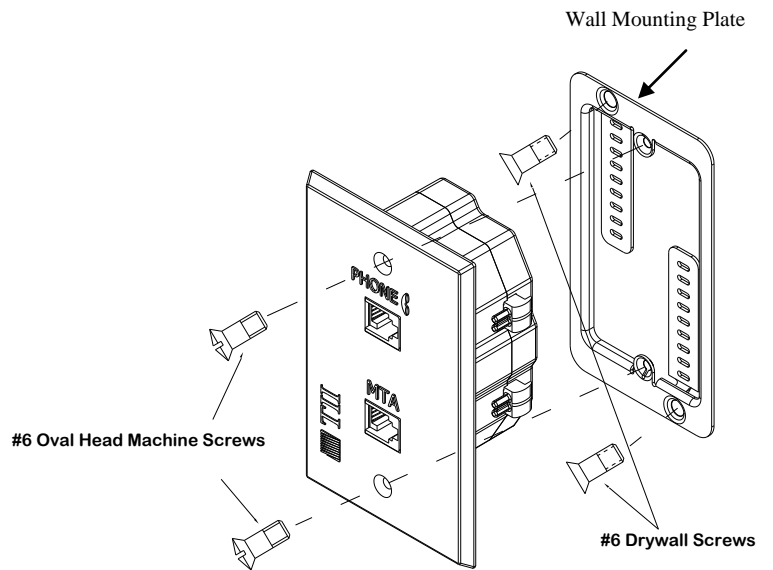

Figure 3

3.9.3 Dress the wires properly inside the wall mounting plate and secure the SVWJ to the junction box using the supplied #6 oval head screw's (See Figure 3).