

CCP7 Series

Fiber Optic ONT Connection Point

FTTH ONT Access Point
Greenfield & Brownfield
Enterprise GPON

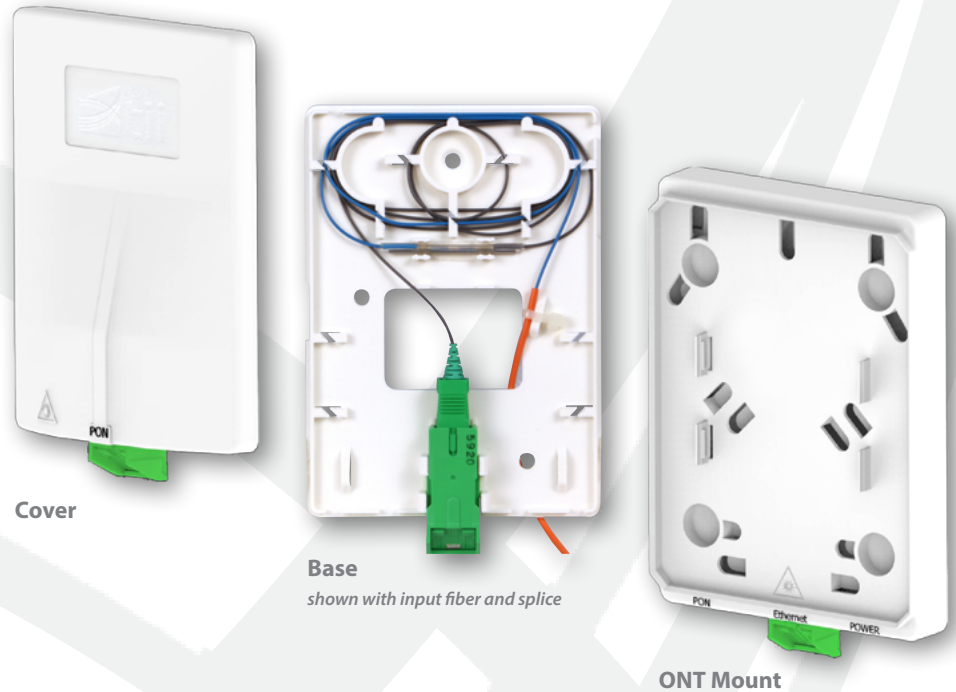

The CCP7 serves as a single fiber connection/demarcation point and is used as the FTTH ONT access point. The unit is directly wall mountable, or may be mounted onto a Single Gang wiring box.

This enclosure provides a secure location for slack storage and fiber connections. An aesthetically pleasing, low profile cover easily snaps over the base. An optional snap on ONT mounting plate is also available to simplify ONT installations. The integrated SC adapter utilizes an internal safety shutter to prevent accidental light exposure, dust contamination, and ferrule damage.

KEY PRODUCT BENEFITS

- ▶ Fiber demarcation/ONT access point
- ▶ Gang box or wall mountable
- ▶ Optionally enables ONT mounting
- ▶ Supports field termination, fusion (2x) or mechanical splice using Fibrlok™ Model 2529
- ▶ Shuttered SC-APC adapter prevents contamination
- ▶ Fiber management and slack storage
- ▶ Multiple cable entry options: rear, bottom, sides
- ▶ Accommodates up to 3mm fiber
- ▶ Tii FPS fiber pathway compatible
- ▶ Low profile, aesthetically pleasing

INDUSTRY STANDARDS

- ▶ cUL Listed
- ▶ TIA/EIA 604-3-A
- ▶ IEC 61754-4



Tii Technologies Inc.

Corporate Headquarters:

141 Rodeo Drive
Edgewood, NY 11717
Phone: 631.789.5000
Fax: 631.789.5063
Toll Free: 888.844.4720
sales@tiitech.com

www.tiitech.com

CCP7 Series

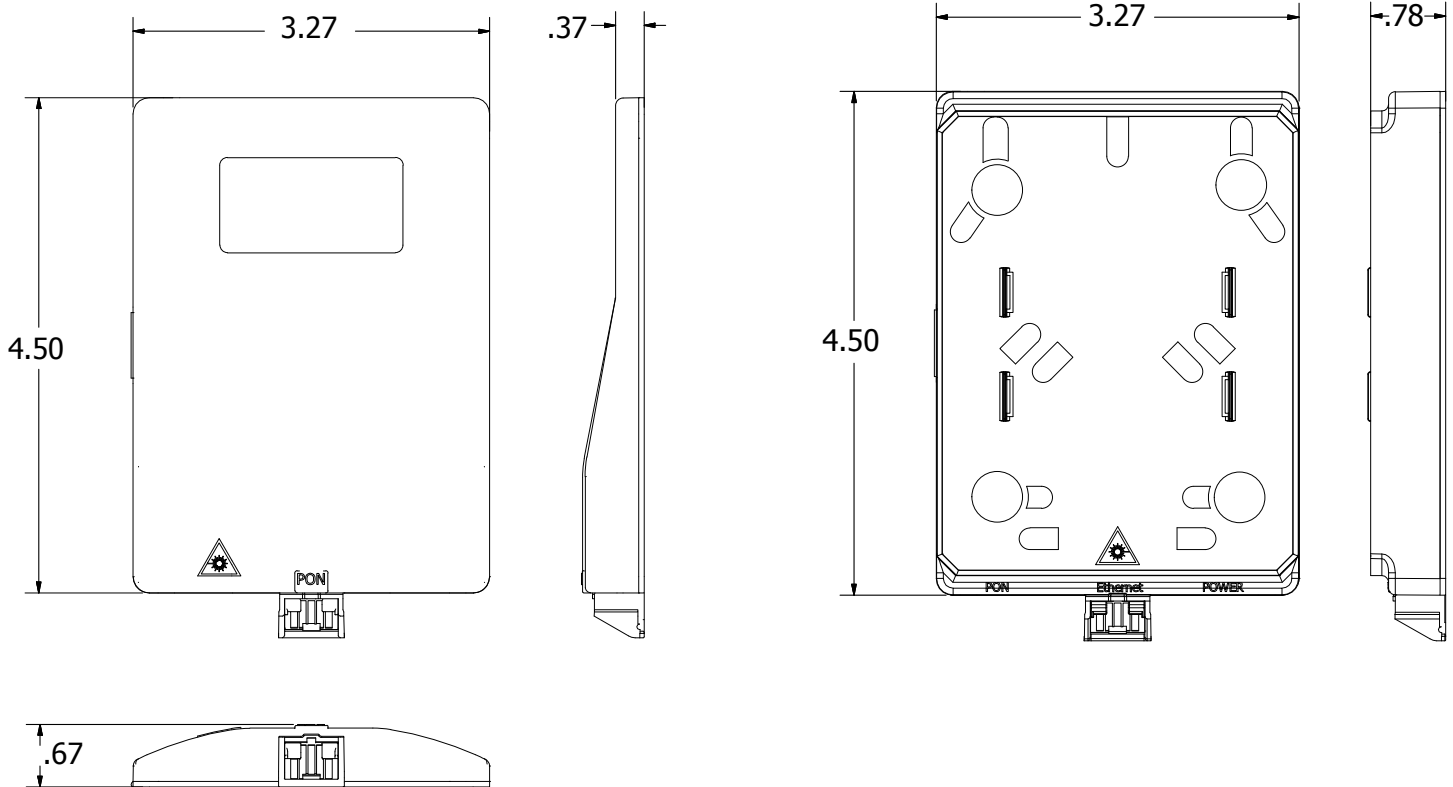

Dimensions are in Inches

SPECIFICATIONS

Interface	Shuttered SC APC Adapter
Splice Capacity	One: Fusion or Fibrlok™
Physical Dimensions	4.5" H x 3.3" W x 0.8" D
Material	Flame retardant thermoplastic, white

ORDERING INFORMATION

Model No.	Description
CCP7-ONT	1 Port SC-APC Fiber Jack with Internal Shutter, Includes Base and ONT Mount Plate
CCP7-BCVR	1 Port SC-APC Fiber Jack with Internal Shutter, Includes Base and Streamlined Cover
CCP7-CVR	Streamlined Cover Plate